

Figure 168. Transfer Case Assembly (M916A1, M916A2, M917A1's) (Sheet 1 of 3)

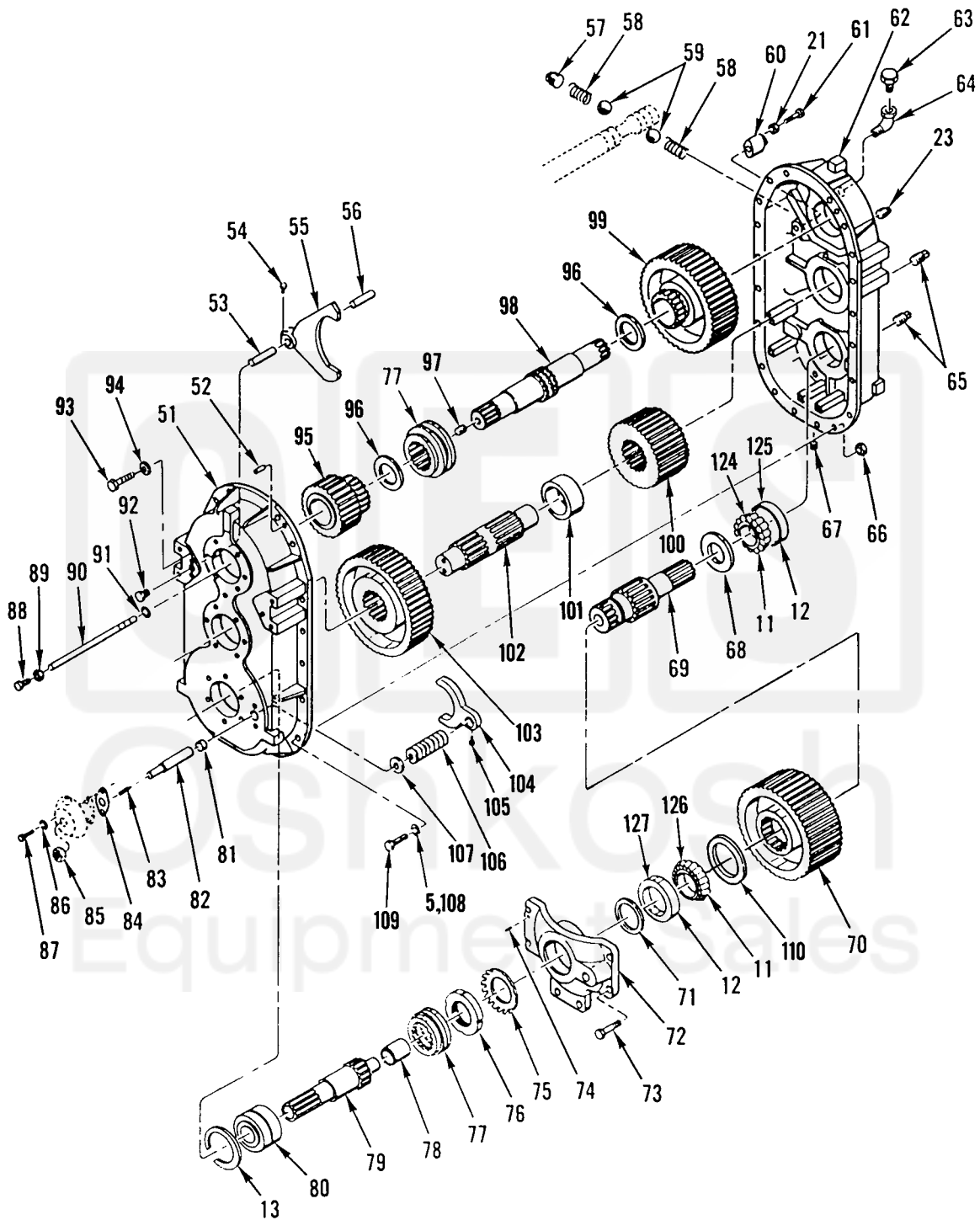

Figure 168. Transfer Case Assembly (M916A1, M916A2, M917A1's) (Sheet 2 of 3)

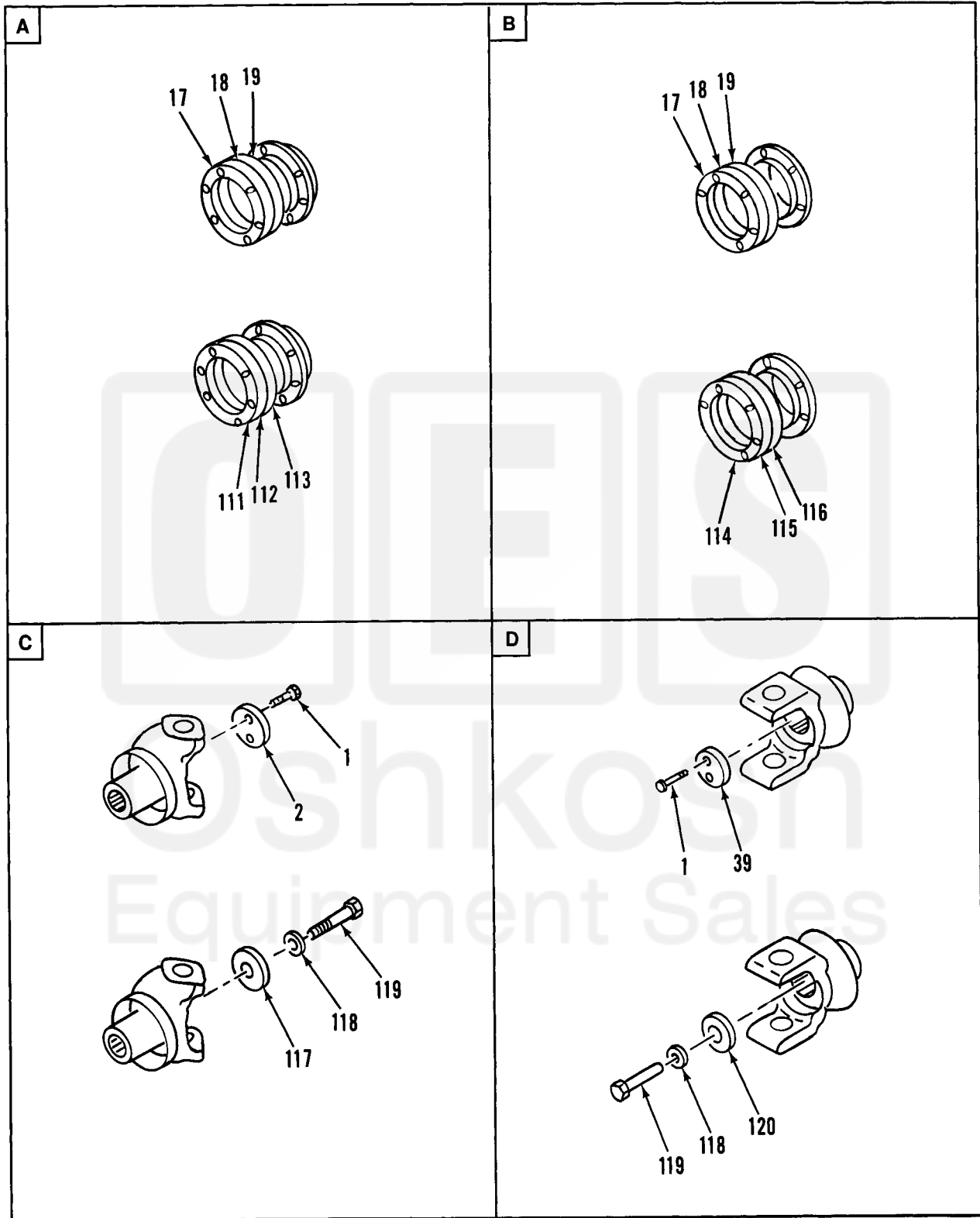

Figure 168. Transfer Case Assembly (M916A1, M916A2, M917A1's) (Sheet 3 of 3)

(1) ITEM NO	(2) SMR CODE	(3) NSN	(4) CAGEC	(5) PART NUMBER	(6) DESCRIPTION AND USABLE ON CODES(UOC)	(7) QTY
GROUP 0801 POWER TRANSFER, FINAL DRIVE, PLANETARY, OR DROP GEARBOX ASSEMBLIES FIG. 168 TRANSFER CASE ASSEMBLY (M916A1, M916A2, M917A1'S)						
1	PAFZZ	5305007320511	80204	B1821BH050C113N	SCREW,CAP,HEXAGON H 1/2-13 UNC X 1.25, STEEL, GR5.....	36
					UOC:6A1,6A2,7A1,7E1	
2	PAFZZ	5340011463138	45152	127272A	COVER,ACCESS QTY=2 6A1, QTY=1 USDE ON ASSY PN: 12466362.....	2
					UOC:6A1,6A2,7A1,7E1	
3	PAFZZ	2520011447308	72447	6-4-2251	YOKE,UNIVERSAL JOIN.....	1
					UOC:6A1,6A2,7A1,7E1	
4	PAFZZ	5330010332697	45152	21726FX	SEAL,PLAIN ENCASED QTY 1 USED ON ASSY PN: 12466362.....	1
					UOC:6A1,6A2,7A1,7E1	
5	PAHZZ	5310011332130	45152	355AX	WASHER,LOCK 1/2 INCH.....	56
					UOC:6A1,6A2,7A1,7E1	
6	PAHZZ	3040011450531	45152	55019CX	PLATE,RETAINING,SHA.....	1
					UOC:6A1,6A2,7A1,7E1	
7	PAHZZ	5365011437436	45152	1317890	SPACER,RING.....	1
					UOC:6A1	
7	PAHZZ	5365010814915	45152	34119AX	SPACER,RING QTY 1 USED ON ASSY PN: 12466362.....	1
					UOC:6A2,7A1,7E1	
8	PAHZZ	3110008425207	60380	WJ485424	RETAINER AND ROLLER.....	4
					UOC:6A1,6A2,7A1,7E1	
9	PAHZZ	5365013306435	45152	55028BX	SPACER,RING.....	2
					UOC:6A1,6A2,7A1,7E1	
10	PAHZZ	5365013302223	45152	55026BX	SPACER,RING.....	2
					UOC:6A1,6A2,7A1,7E1	
11	PAHZZ	3110001000661	45152	462TA45	CONE AND ROLLERS,TA QTY 2 USED ON INPUT SHAFT FOR ASSY PN: 12466362...	6
					UOC:6A1,6A2,7A1,7E1	
12	PAHZZ	3110001000333	45152	55023AX	CUP,TAPERED ROLLER QTY 2 USED ON INPUT SHAFT FOR ASSY PN: 12466362...	6
					UOC:6A1,6A2,7A1,7E1	
13	PAHZZ	5325001701693	72800	NAN412	RING,RETAINING.....	2
					UOC:6A1,6A2,7A1,7E1	
14	PFHZZ	2520011471378	45152	1304240	CAP,DUST,PROPELLER.....	1
					UOC:6A1,6A2,7A1,7E1	
15	PFHZZ	3040011447314	45152	1304230	PLATE,RETAINING,SHA.....	1
					UOC:6A1,6A2,7A1,7E1	
16	PAHZZ	5305000712069	80204	B1821BH050C150N	SCREW,CAP,HEXAGON H 1/2-13UNC-2A X 1.500.....	8
					UOC:6A1,6A2,7A1,7E1	
17	PAHZZ	5365010815323	45152	55084BX	SPACER,PLATE.....	9
					UOC:6A1,6A2,7A1,7E1	
18	PAHZZ	5365010819747	45152	55085BX	SHIM QTY 3 USED ON ASSY PN: 12466362.....	9
					UOC:6A1,6A2,7A1,7E1	

(1) ITEM NO	(2) SMR CODE	(3) NSN	(4) CAGEC	(5) PART NUMBER	(6) DESCRIPTION AND USABLE ON CODES(UOC)	(7) QTY
19	PBHZZ	5365010819748	45152	55086BX	SHIM QTY 3 USED ON ASSY PN: 12466362..... UOC: 6A1, 6A2, 7A1, 7E1	9
20	PAHZZ	2520011463139	45152	1304170	HOUSING, POWER TAKE-..... UOC: 6A1, 6A2, 7A1, 7E1	1
21	PAFZZ	5310010688446	45152	354AX	WASHER, LOCK..... UOC: 6A1, 6A2, 7A1, 7E1	6
22	PAFZZ	5306002264841	80204	B1821BH031C400N	BOLT, MACHINE 5/16-18UNC-21 X 4.000. UOC: 6A1, 6A2, 7A1, 7E1	4
23	PAHZZ	4730002212139	72452	1459-259	PLUG, PIPE..... UOC: 6A1, 6A2, 7A1, 7E1	2
24	PAFZZ	4730002784311	45152	3454FX	ADAPTER, STRAIGHT, PI..... UOC: 6A1	1
24	PAFZZ	4730012064810	45152	10258FX	ELBOW, PIPE TO TUBE USED ON ASSY PN: 12466362..... UOC: 6A2, 7A1, 7E1	1
25	AFFFF		45152	58989AX-U	HOSE ASSY..... UOC: 6A1	1
25	PAFZZ	4730014395564	01276	FA7269JJJ0220	COUPLING ASSEMBLY, H USED ON ASSY PN: 12466362..... UOC: 6A2, 7A1, 7E1	1
26	PAHZZ	4730005682258	01276	411-10S	.ADAPTER, STRAIGHT, TU..... UOC: 6A1	2
27	MFFZZ		45152	47338AX.	.HOSE, NONMETALLIC MAKE FROM CAGE 01276, PN FC350-10, 19 IN..... UOC: 6A1	19
28	PAFZZ	4730002871028	96906	MS20822-10D	ELBOW, PIPE TO TUBE 7/8-14UNJF-3A... UOC: 6A1, 6A2, 7A1, 7E1	1
29	PAFZZ	4730005120037	45152	55136AX	STRAINER ELEMENT, SE..... UOC: 6A1, 6A2, 7A1, 7E1	1
30	AFFFF		45152	47554AX-U	HOSE ASSY..... UOC: 6A1	1
30	PAFZZ	4720013567391	45152	47554AX12U	HOSE ASSEMBLY, NONME USED ON ASSY PN: 12466362..... UOC: 6A2, 7A1, 7E1	1
31	PAFZZ	4730011033275	96906	MS51508A6	.ELBOW, PIPE TO TUBE 3/8 OD X 1/ 4NPTF..... UOC: 6A1	1
32	PAFZZ	4730010657552	01276	411-6S	.ADAPTER, STRAIGHT, TU..... UOC: 6A1	2
33	MFFZZ	4720012119457	45152	47336AX.	.HOSE, NONMETALLIC MAKE FROM CAGE 01276, PN FC350-06, 12 IN..... UOC: 6A1	12
34	PAFZZ	4730009476104	96906	MS51504A6-8S	ELBOW, PIPE TO TUBE 3/8 OD X 1/2NPTF UOC: 6A1, 6A2, 7A1, 7E1	1
35	PAFZZ	4730002790985	81348	WW-P-471AASBCB	PLUG, PIPE..... UOC: 6A1	1
36	PFFZZ	3110011458482	45152	55022DX	PLATE, RETAINING, BEA..... UOC: 6A1	1
36	PFFZZ	3110013469776	45152	1691980	PLATE, RETAINING, BEA USED ON ASSY PN: 12466362..... UOC: 6A2, 7A1, 7E1	1

WP 0002 00

TM 9-2320-363-24P

(1) ITEM NO	(2) SMR CODE	(3) NSN	(4) CAGEC	(5) PART NUMBER	(6) DESCRIPTION AND USABLE ON CODES(UOC)	(7) QTY
37	PAFZZ	5330011474919	45152	55079AX	SEAL,PLAIN ENCASED..... UOC:6A1	1
37	PAFZZ	5330013409882	01212	415023-SSR	SEAL,PLAIN ENCASED USED ON ASSY PN: 12466362..... UOC:6A2,7A1,7E1	1
38	PAFZZ	2520012142564	45152	1426350	YOKE,UNIVERSAL JOIN..... UOC:6A1	1
38	PBFZZ	2520014350410	7H161	6-4-9151X	YOKE,UNIVERSAL JOIN USED ON ASSY PN: 12466362..... UOC:6A2,7A1,7E1	1
39	PFFZZ	5365011476789	45152	127273A	SPACER,PLATE..... UOC:6A1	1
40	PFHZZ	3130011478112	45152	55021CX	HOUSING,BEARING UNI..... UOC:6A1	1
40	PAHZZ	3130014399129	45152	2207600	BEARING UNIT,PLAIN USED ON ASSY PN: 12466362..... UOC:6A2,7A1,7E1	1
41	PFHZZ	4730002029539	45152	166JX	REDUCER,TUBE..... UOC:6A1	1
42	PAHZZ	3120005967688	45152	39745AX	BEARING,WASHER,THRU..... UOC:6A1	1
43	PAHZZ	3120011469782	45152	40393AX	BEARING,WASHER,THRU..... UOC:6A1	1
44	PAHZZ	5360011454724	45152	53733AX	SPRING,HELICAL,COMP..... UOC:6A1	1
45	PAHZZ	3040011448220	45152	61154BX	SHAFT,SHOULDERED..... UOC:6A1	1
46	PAHZZ	5306012343782	45152	1413020	BOLT,MACHINE HEXAGON HEAD,0.375 X 1.5 IN,STEEL..... UOC:6A1,6A2,7A1,7E1	2
47	PFHZZ	3040012049801	45152	1432440	PLATE,RETAINING,SHA..... UOC:6A1	1
47	XDHZZ		45152	2212020	RING,SPEEDO SENSOR USED ON ASSY PN: 12466362..... UOC:6A2,7A1,7E1	1
48	PAHZZ	5365003505442	45152	5824FX	PLUG,MACHINE THREAD..... UOC:6A1	1
48	PAHZZ	4730007019364	19207	7019364	PLUG,PIPE USED ON ASSY PN: 12466362 UOC:6A2,7A1,7E1	1
49	PBFZZ	2520012446153	72447	6.5-4-3711X	YOKE,UNIVERSAL JOIN..... UOC:6A1	1
49	PBFZZ	2520014350414	72447	6.5-4-4401X	YOKE,UNIVERSAL JOIN USED ON ASSY PN: 12466362..... UOC:6A2,7A1,7E1	1
50	PAFZZ	5365010814915	45152	34119AX	SPACER,RING..... UOC:6A1	1
51	XAHZZ		45152	1693790	HOUSING,FRONT..... UOC:6A1	1
51	XAHZZ		45152	1969540	HOUSING,FRONT USED ON ASSY PN: 12466362..... UOC:6A2,7A1,7E1	1
52	PAHZZ	5315010812925	45152	55075AX	PIN,STRAIGHT,HEADLE.....	2

WP 0002 00

TM 9-2320-363-24P

(1) ITEM NO	(2) SMR CODE	(3) NSN	(4) CAGEC	(5) PART NUMBER	(6) DESCRIPTION AND USABLE ON CODES(UOC)	(7) QTY
53	PAHZZ	5365011436445	45152	59902AX	UOC: 6A1, 6A2, 7A1, 7E1 SPACER, SLEEVE.....	1
54	PAHZZ	5306011721556	45152	335BX2	UOC: 6A1, 6A2, 7A1, 7E1 BOLT FORK RETAINER.....	2
55	PAHZZ	2520011447307	45152	64209CX	UOC: 6A1, 6A2, 7A1, 7E1 SHIFTER FORK, VEHICU.....	1
56	PAHZZ	5365011447377	45152	59903AX	UOC: 6A1, 6A2, 7A1, 7E1 SPACER, SLEEVE.....	1
57	PAHZZ	4730002212136	96906	MS20913-1S	UOC: 6A1, 6A2, 7A1, 7E1 PLUG, PIPE.....	1
58	PAHZZ	5360010861419	45152	54396AX	UOC: 6A1, 6A2, 7A1, 7E1 SPRING, HELICAL, COMP.....	2
59	PAHZZ	3110009491438	45152	52776AX	UOC: 6A1, 6A2, 7A1, 7E1 BALL, BEARING.....	2
60	PFHZZ	5340011448237	45152	1321590	UOC: 6A1, 6A2, 7A1, 7E1 COVER, ACCESS.....	1
61	PAHZZ	5305011464538	45152	2108HX1	UOC: 6A1, 6A2, 7A1, 7E1 SCREW, CAP, HEXAGON H.....	2
62	PFHZZ	2520013300770	45152	117937R	UOC: 6A1, 6A2, 7A1, 7E1 TRANSFER TRANSMISSI HOUSING, REAR...	1
62	XAHZZ		45152	2004690	UOC: 6A1 TRANSFER TRANSMISS USED ON ASSY PN: 12466362, HOUSING, REAR.....	1
63	PAOZZ	2520003957722	00736	MBGFPM	UOC: 6A1, 6A2, 7A1, 7E1 BREATHER.....	1
64	PAFZZ	4730002534413	96906	MS39230-3	UOC: 6A1 ELBOW, PIPE 3/4NPT.....	1
65	PAFZZ	4730002212140	96906	MS20913-6S	UOC: 6A1, 6A2, 7A1, 7E1 PLUG, PIPE 3/4-14NPT.....	2
66	PAFZZ	5310010570822	45152	1768HX1	UOC: 6A1, 6A2, 7A1, 7E1 NUT, PLAIN, HEXAGON .500-13UNC-2B....	20
67	PAFZZ	4730010439027	45152	2128HX	UOC: 6A1, 6A2, 7A1, 7E1 PLUG, PIPE, MAGNETIC.....	1
68	PAHZZ	5365013306436	45152	55029BX	UOC: 6A1, 6A2, 7A1, 7E1 SPACER, RING.....	1
68	PAHZZ	5365014392298	45152	1969510	UOC: 6A1 SPACER, SLEEVE USED ON ASSY PN: 12466362.....	1
69	PAHZZ	3040011447024	45152	127270D	UOC: 6A2, 7A1, 7E1 SHAFT, SHOULDERED.....	1
69	PAHZZ	3040014393507	45152	2004680	UOC: 6A1 SHAFT, SHOULDERED USED ON ASSY PN: 12466362.....	1
70	PAHZZ	3020011446418	45152	115406D	UOC: 6A2, 7A1, 7E1 GEAR, HELICAL.....	1
71	PAHZZ	5365010813424	45152	55030BX	UOC: 6A1, 6A2, 7A1, 7E1 SPACER, RING.....	1
72	PFHZZ	3110011565506	45152	111805R	UOC: 6A1, 6A2, 7A1, 7E1 PLATE, RETAINING, BEA.....	1
72	PAHZZ	3130013386992	45152	1839010	UOC: 6A1 HOUSING, BEARING UNI USED ON ASSY PN: 12466362.....	1

(1) ITEM NO	(2) SMR CODE	(3) NSN	(4) CAGEC	(5) PART NUMBER	(6) DESCRIPTION AND USABLE ON CODES(UOC)	(7) QTY
73	PAHZZ	5305000711787	80204	B1821BH044C113N	UOC:6A2,7A1,7E1 SCREW,CAP,HEXAGON H 7/16-14UNC-2A X 1.125.....	6
73	PAHZZ	5305000712069	80204	B1821BH050C150N	UOC:6A1 SCREW,CAP,HEXAGON H 1/2-13X1.5 USED ON ASSY PN: 12466362.....	1
74	PAHZZ	5315001563104	45152	30190AX	UOC:6A2,7A1,7E1 PIN,DOWEL.....	2
75	PAHZZ	5310001860977	45152	13388FX	UOC:6A1 WASHER,KEY 3.612 ID X 4.938 OD X .100 THK.....	1
76	PAHZZ	5310002439295	45152	13387FX	UOC:6A1,6A2,7A1,7E1 NUT,PLAIN,ROUND SPANNER JAM.....	1
77	PAFZZ	3040011448238	45152	55025BX	UOC:6A1,6A2,7A1,7E1 COLLAR,SHAFT.....	2
78	PAHZZ	3120011436442	45152	1594FX	UOC:6A1 BUSHING,SLEEVE.....	1
79	PAHZZ	3040011448219	45152	127268D	UOC:6A1 SHAFT,SHOULDERED.....	1
79	PAHZZ	3040013384434	45152	1843710	UOC:6A1 SHAFT,SHOULDERED USED ON ASSY PN: 12466362.....	1
80	PAHZZ	3110001639904	45152	44221BX	UOC:6A2,7A1,7E1 BEARING,ROLLER,TAPE.....	1
80	PAHZZ	3110013386931	60038	39590 ASSY 902A3	UOC:6A1 BEARING,ROLLER,TAPE USED ON ASSY PN: 12466362.....	1
81	PAHZZ	2520010413542	45152	31425BX	UOC:6A2,7A1,7E1 RING,PILOT.....	1
82	PAHZZ	3040011448218	45152	63219CX	UOC:6A1,6A2,7A1,7E1 SHAFT,SHOULDERED.....	1
82	PAHZZ	3040013387521	45152	1693480	UOC:6A1 SHAFT,SHOULDERED USED ON ASSY PN: 12466362.....	1
83	PAFZZ	5307011451644	45152	63216AX	UOC:6A2,7A1,7E1 STUD,PLAIN.....	1
84	PAFZZ	5330007927524	45152	13308FX	UOC:6A1,6A2,7A1,7E1 GASKET.....	1
85	PAFZZ	5310009824912	96906	MS21045-5	UOC:6A1 NUT,SELF-LOCKING,HE .3125-24UNJF-3B UOC:6A1	1
86	PAFZZ	5310011290450	45152	351AX	UOC:6A1 WASHER,LOCK 0.382 ID X 0.683 OD X 0.094 THK, STEEL.....	2
87	PAFZZ	5306010845390	45152	420AX1	UOC:6A1,6A2,7A1,7E1 BOLT,MACHINE HEXAGON HEAD,0.375 X 0.96 IN,STEEL.....	2
88	PAHZZ	5340011453255	45152	59899AX	UOC:6A1,6A2,7A1,7E1 CONNECTOR,ROD END.....	1
89	PAHZZ	5310008348734	96906	MS35691-37	UOC:6A1,6A2,7A1,7E1 NUT,PLAIN,HEXAGON 1/2-20UNF.....	1
90	PAHZZ	3040011448216	45152	105761C	UOC:6A1,6A2,7A1,7E1 SHAFT,STRAIGHT.....	1

WP 0002 00

TM 9-2320-363-24P

(1) ITEM NO	(2) SMR CODE	(3) NSN	(4) CAGEC	(5) PART NUMBER	(6) DESCRIPTION AND USABLE ON CODES(UOC)	(7) QTY
91	PAHZZ	5330003509711	18876	10291590	UOC: 6A1, 6A2, 7A1, 7E1 SEAL, PLAIN ENCASED.....	1
92	PAFZZ	47300022212138	94894	1837	UOC: 6A1, 6A2, 7A1, 7E1 COUPLING HALF, QUICK.....	1
93	PAFZZ	5306010617416	45152	1366HX1	UOC: 6A1, 6A2, 7A1, 7E1 BOLT, MACHINE 5/16-18X5/8, USED ON ASSY PN: 12466362.....	2
94	PAFZZ	5310010617452	45152	1804HX	UOC: 6A2, 7A1, 7E1 WASHER, FLAT 5/16 USED ON ASSY PN: 12466362.....	2
95	PAHZZ	3020011446426	45152	115403D	UOC: 6A2, 7A1, 7E1 GEAR CLUSTER.....	1
96	PAHZZ	5365013322150	45152	55027BX	UOC: 6A1, 6A2, 7A1, 7E1 SPACER, RING.....	2
97	PAHZZ	4730000444861	45152	57CX138	UOC: 6A1, 6A2, 7A1, 7E1 PLUG, PIPE.....	1
98	PAHZZ	3040011446357	45152	1315270	UOC: 6A1, 6A2, 7A1, 7E1 SHAFT, SHOULDERED.....	1
99	PAHZZ	3020011448499	45152	115407D	UOC: 6A1, 6A2, 7A1, 7E1 GEAR CLUSTER.....	1
100	PAHZZ	3020011446417	45152	115404D	UOC: 6A1, 6A2, 7A1, 7E1 GEAR, HELICAL.....	1
101	PAHZZ	5365013302224	45152	55031BX	UOC: 6A1, 6A2, 7A1, 7E1 SPACER, RING.....	1
102	PAHZZ	3040011448217	45152	111295D	UOC: 6A1, 6A2, 7A1, 7E1 SHAFT, SHOULDERED.....	1
103	PAHZZ	3020011449291	45152	115405D	UOC: 6A1, 6A2, 7A1, 7E1 GEAR, HELICAL.....	1
104	PAHZZ	2520011448603	45152	55042CX	UOC: 6A1, 6A2, 7A1, 7E1 SHIFTER FORK, VEHICU.....	1
105	PAHZZ	5305002758530	45152	5106FX	UOC: 6A1, 6A2, 7A1, 7E1 SETSCREW .938 X 20UNF-3A.....	1
106	PAHZZ	5310011436462	45152	47736AX	UOC: 6A1, 6A2, 7A1, 7E1 WASHER, SPRING TENS.....	8
107	PAHZZ	5310011436449	45152	55068BX	UOC: 6A1, 6A2, 7A1, 7E1 WASHER, FLAT 1.090 ID X 2.000 OD X .190 THK.....	1
108	PAHZZ	5310005845272	96906	MS35338-48	UOC: 6A1, 6A2, 7A1, 7E1 WASHER, LOCK 1/2 INCH, USED ON ASSY PN: 12466362.....	20
109	PAHZZ	5305007250135	96906	MS90727-138	UOC: 6A2, 7A1, 7E1 SCREW, CAP, HEXAGON H 9/16-18UNF X 1.500.....	20
109	PAHZZ	5305000712067	80204	B1821BH050C125N	UOC: 6A1 SCREW, CAP, HEXAGON H 1/2-13X1.25GR8, USED ON ASSY PN: 12466362.....	20
110	XDHZZ		45152	1969520	UOC: 6A2, 7A1, 7E1 SPACER, PLATE USED ON ASSY PN: 12466362.....	1
111	PAHZZ	5365013390962	45152	1709070	UOC: 6A2, 7A1, 7E1 SHIM USED ON ASSY PN: 12466362.....	3

WP 0002 00

TM 9-2320-363-24P

(1) ITEM NO	(2) SMR CODE	(3) NSN	(4) CAGEC	(5) PART NUMBER	(6) DESCRIPTION AND USABLE ON CODES(UOC)	(7) QTY
112	PAHZZ	5365013390961	45152	1709080	SHIM USED ON ASSY PN: 12466362..... UOC:6A2,7A1,7E1	3
113	PAHZZ	5365013388222	45152	1709060	SPACER,PLATE USED ON ASSY PN: 12466362..... UOC:6A2,7A1,7E1	3
114	PAHZZ	5365013390965	45152	1843590	SPACER,PLATE USED ON ASSY PN: 12466362..... UOC:6A2,7A1,7E1	3
115	PAHZZ	5365013418961	45152	1843580	SHIM USED ON ASSY PN: 12466362..... UOC:6A2,7A1,7E1	3
116	PAHZZ	5365013394027	45152	1843660	SHIM USED ON ASSY PN: 12466362..... UOC:6A2,7A1,7E1	3
117	PAFZZ	5310013388184	45152	1888370	WASHER,FLAT USED ON ASSY P/N: 12466362..... UOC:6A2,7A1,7E1	1
118	PAFZZ	5310012144946	45152	2083HX	WASHER,FLAT 3/4 INCH. USED ON ASSY PN: 12466362..... UOC:6A2,7A1,7E1	2
119	PAFZZ	5305013387301	45152	60026AX	SCREW,CAP,HEXAGON H 3/4-10X2.50 USED ON ASSY PN: 12466362..... UOC:6A2,7A1,7E1	2
120	PFFZZ	5310013390243	45152	1704630	WASHER,FLAT USED ON ASSY PN: 12466362..... UOC:6A2,7A1,7E1	1
121	PAFZZ	5330007251511	10988	G13824	SEAL,PLAIN ENCASED USED ON ASSY PN: 12466362..... UOC:6A2,7A1,7E1	1
122	PAHZA	3110002272340	60038	H414242H414210	BEARING,ROLLER,TAPE CONE/CUP SET, USED ON ASSY P/N: 12466362..... UOC:6A2,7A1,7E1	2
123	PAHZZ	4730013383675	45152	1689980	FLANGE,PIPE USED ON ASSY P/N: 12466362..... UOC:6A2,7A1,7E1	1
124	PAHZZ	3110001000670	60038	663	CONE AND ROLLERS,TA USED ON ASSY P/ N: 12466362..... UOC:6A2,7A1,7E1	1
125	PAHZZ	3110001000335	60038	653	CUP,TAPERED ROLLER USED ON ASSY P/ N: 12466362..... UOC:6A2,7A1,7E1	1
126	PAHZZ	3110006180248	60038	HM218248	CONE AND ROLLERS,TA USED ON ASSY P/ N: 12466362..... UOC:6A2,7A1,7E1	1
127	PAHZZ	3110006180249	60038	HM218210	CUP,TAPERED ROLLER USED ON ASSY P/ N: 12466362..... UOC:6A2,7A1,7E1	1

END OF FIGURE